



**GM**  
**DURAMAX**  
2001-2007 V8-6.6L (td)  
LB7/LLY/LBZ

P/N  
49-44003  
49-14003

# DIESEL EXHAUST



## Features:

- High performance
- 4" mandrel-bent
- 409 SS or aluminized
- Lowers EGT's
- OE style clamps and hangers

## Benefits:

- + 29% flow increase
- + 19 lbs x ft torque
- + 9 H.P.



[aFepower.com](http://aFepower.com)





# Installation Instructions for: GM DURAMAX 2001-2007 V8-6.6L (td) LB7/LLY/LBZ

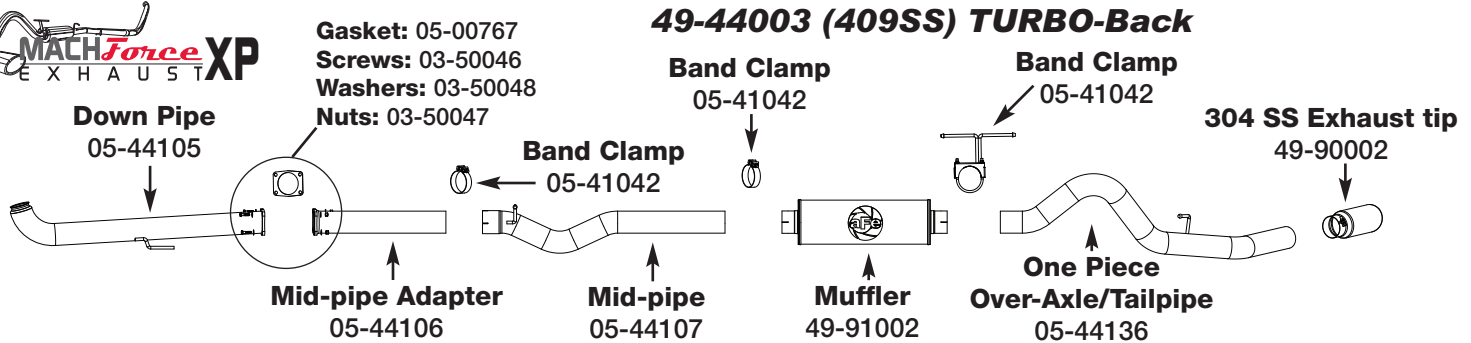

**Step 1: (Read Instructions prior to installation)** Remove your stock exhaust from the rear of your truck working your way forward. It may be necessary to cut the pipes if the slip joints are stuck. Take caution not to damage the factory isolation mounts as they will be reused. *It is recommended to not fully tighten the clamps until the entire system has been installed.*

**Step 2:** For faster installation spread the pieces of the exhaust along side of your vehicle according to the diagram shown.

**Step 3:** Install the down pipe leaving the Turbo band clamp loose for adjustments. Then assemble and install the mid-pipe adapter using the gasket,nuts,screws, and washer provided. Do not fully tighten at this time.

**Step 4:** Slip the hanger clamp onto the muffler and install the over-axle/tailpipe from the rear into the muffler.

**Step 5:** Slip band clamps over the ends of the mid-pipe prior to installation. Now install the mid-pipe. Test fit first as the mid-pipe will require cutting at the muffler end to fit shorter wheelbases. At this time tighten all clamps from front to rear.

**Step 6:** Install the exhaust tip and tighten. Your installation is now complete. It is recommended to re-tighten all parts after 50-100 miles.

## LARGE BORE HD Exhaust

### 49-14003 (Aluminized) TURBO-Back

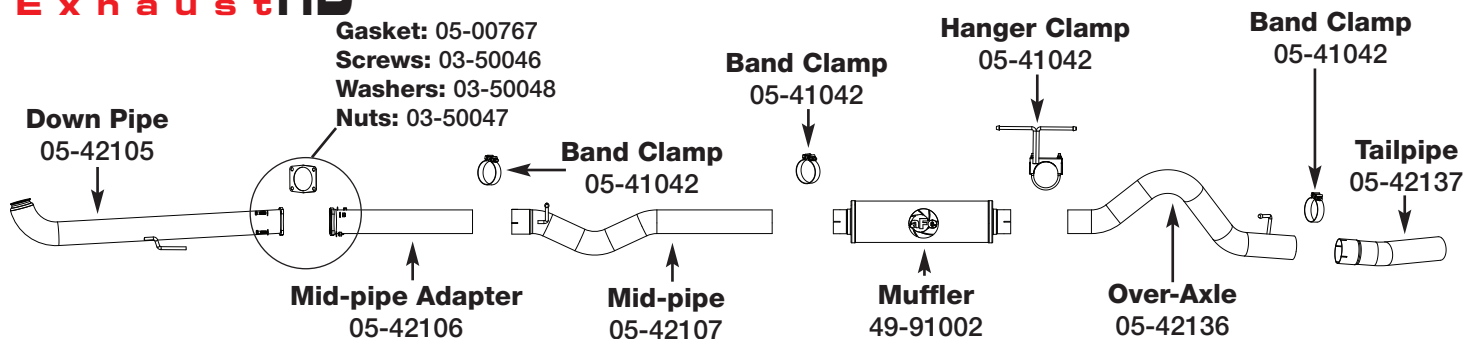

**Step 1, 2 and 3:** See above

**Step 4:** Slip the hanger clamp onto the muffler and install the over-axle pipe from the rear into the muffler..

**Step 5:** Slip band clamps over the ends of the mid-pipe prior to installation. Now install the mid-pipe. Test fit first as the mid-pipe will require cutting at the muffler end to fit shorter wheelbases. At this time tighten all clamps from front to rear.

**Step 6:** Slip band clamp over expanded end of tailpipe prior to installation. Now install tailpipe an tighten band clamp. Your installation is now complete. It is recommended to re-tighten all parts after 50-100 miles.

**NOTE:**

- aFe recommends that the tailpipe be at least 1/2"-1" away from any body panels to avoid heat related body damage. **Tighten and secure.**

**Caution:** Allow time for your vehicle to cool down prior to installation. When working on or under your vehicle proceed with caution. Exhaust systems reach high temperatures and may cause serious burns. Wear protective safety equipment; eye goggles and gloves to ensure a safe installation. **aFe recommends professional installation on our products.**