



Installation Instructions

NEUTRAL/PARK START SAFETY SWITCH

HURST FRONT CABLE QUARTER STICK

#248-8600

IMPORTANT - IF YOU ARE NOT CONFIDENT OF THE INSTALLATION SKILLS REQUIRED TO PROPERLY INSTALL THE HURST NEUTRAL/PARK START SAFETY SWITCH, WE STRONGLY RECOMMEND HAVING IT INSTALLED BY A CERTIFIED AUTOMOTIVE MECHANIC. IMPROPER ASSEMBLY/INSTALLATION CAN CAUSE A MALFUNCTION, RESULTING IN POSSIBLE SERIOUS BODILY INJURY.

1. Vehicle must have engine off, parking brake securely engaged, wheels blocked, with transmission and shifter in neutral position for proper switch installation.
2. Prewire the switch (Item 2) using two female crimp connectors (Item 11) and two suitable lengths of 16 gauge, insulated automotive grade wire. Crimp a connector to one end of each wire, then push onto each switch terminal. See wiring illustration 3.
3. Remove right side, lower hex-head cap screw and washer from shifter handle. See illustration (2).
4. Use trigger to shift stick back to gain access to gear position detent plate. This allows access to back end of cable pin. Engage the hole in eye bracket (Item 3) over back end of cable pin. See illustration (2).
5. Use trigger to move stick back into neutral position and refasten lower hex head cap screw and washer. Eye bracket (Item 3) should be located between stick and gear position detent plate. **Note: Eye bracket must rotate freely.**
6. Position bottom pinholes of switch housing assembly (Item 4) to align with front pin holes on base of shifter. With a ring clip (Item 5) on one end, position groove pin (Item 6) through pin holes in shifter base and switch housing assembly. When groove pin is properly positioned, install remaining clip on other end of groove pin. **Note: When using Hurst Quick-Release floor plate and/or aluminum cover, substitute one quick-release pin for groove pin and clips in Step 6 above.**
7. The slide cam (Item 7) of the switch requires adjustment to function properly. Verify stick and transmission are in neutral position. To adjust slide cam, loosen cam to bracket securing screw (Item 8). Advance or retard slide cam as required to either side of middle position. Retighten securing screw. **Switch should only allow engine starting when shifter is in neutral or park positions.** Check switch/shifter several times for proper operation. **NOTE: Install with "A" side of slide cam (Item 7) facing up for all front-mounted cable shifters. Side "B" should face up for all rear-mounted cable shifters. Side identifications are molded into faces of slide cam.**
8. Installation is now complete. Check switch/shifter for proper operation before each use. Securely tighten all fasteners.

Illustration 1.

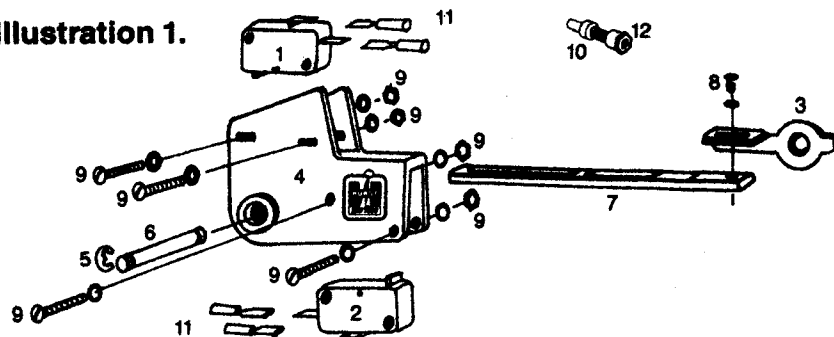

1. BACK-UP LIGHT SWITCH (SEPARATE KIT)
2. NEUTRAL/PARK SAFETY SWITCH
3. EYE BRACKET
4. SWITCH HOUSING ASSEMBLY
5. RING CLIP
6. GROOVE PIN
7. SLIDE CAM
8. SECURING SCREW AND LOCK WASHER
9. 440 SCREWS, WASHERS AND NUTS
10. THREAD STUD (REAR CABLE ONLY)
11. FEMALE CONNECTOR
12. SLEEVE NUT

Illustration 3.

NEUTRAL/PARK SWITCH WIRING DIAGRAM (GENERAL)

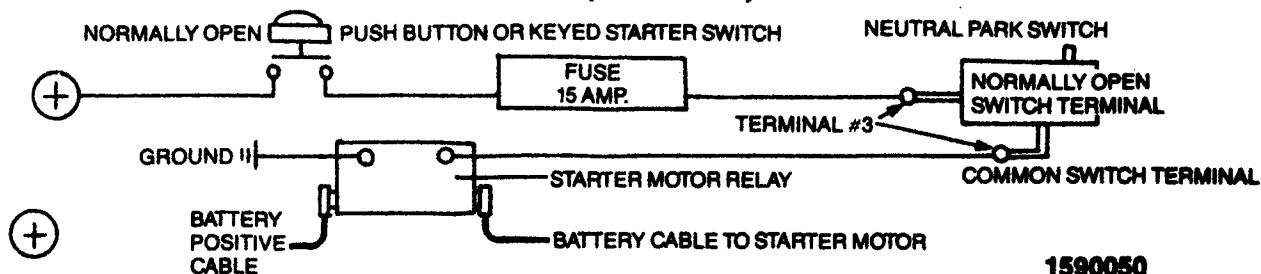

1590050

Installation Instructions

REAR CABLE QUARTER STICK

Steps 1, 2, 3, and 6, 7, 8 same as Front Cable Quarter Stick Installation.

4. Index stick and gear position detent plate so cable stud is accessible for removal. Remove cable stud and replace with longer screw-in stud (Item 10). **Note: Use Loctite thread locker #242 on new stud for positive mounting.**
5. Slip sleeve nut (Item 12) through hole in eye bracket and fasten to exposed threaded stud. Use trigger to align stick and gear position detent plate to neutral position. Re-fasten lower hex-head cap screw and washer to stick. **Note: Eye bracket must rotate freely. See illustration (2A).**

Illustration 2A.
REAR CABLE MOUNT

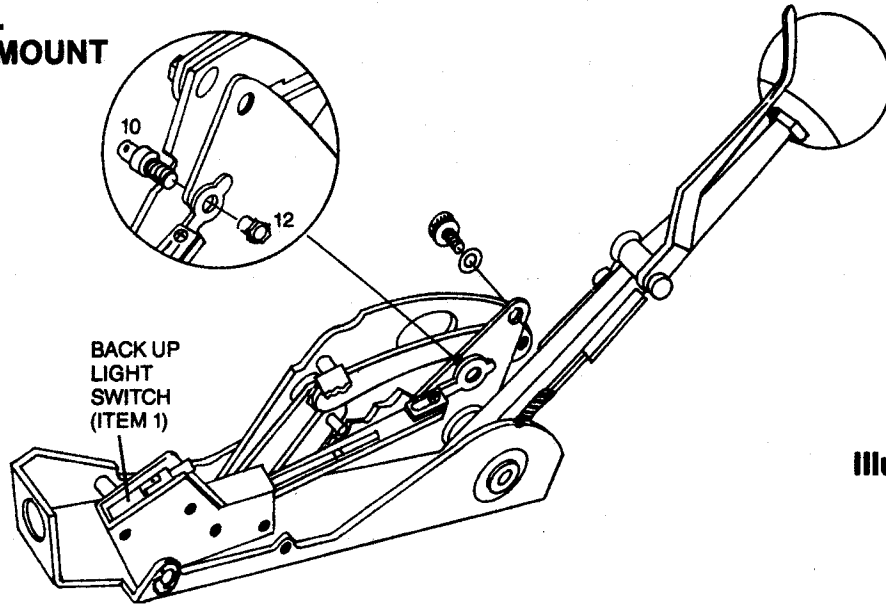

Illustration 2.

BACK-UP LIGHT SWITCH INSTRUCTIONS

FRONT CABLE QUARTER STICK #248-8601

1. Vehicle must have engine off, parking brake securely engaged, and wheels blocked. Put shifter into reverse gear position. (Rear cable shifters are not equipped for back up lights.)
2. Slide switch into top opening of housing so the wire terminals are up and facing the stick, use the #440 fasteners (Item 9) to secure the back-up light switch to housing (Item 4). Use washers under each screw head and nut.
3. Use female crimp connectors (Item 11) and two suitable lengths of 16 gauge automotive grade insulated wire. Crimp a connector to one end of each wire, then push onto each back-up light switch terminal (see Illustration 4).
4. Adjustment of switch is accomplished by loosening the #440 fasteners and moving the switch (Item 1) backward and forward until the reverse lights are activated. Once the switch is properly positioned, retighten #440 fasteners. Back-up lights should light only when shifter is in reverse position. Route all wiring away from sharp corners or edges and hot (above 200°F) vehicle components. Secure wire routing using either nylon wire ties or black electrical tape. See wiring Illustration 4. **Note: Back up light switch must be used in conjunction with #248-8600 Neutral Park Start Safety Switch.**

Illustration 4.
BACK UP LIGHT WIRING DIAGRAM

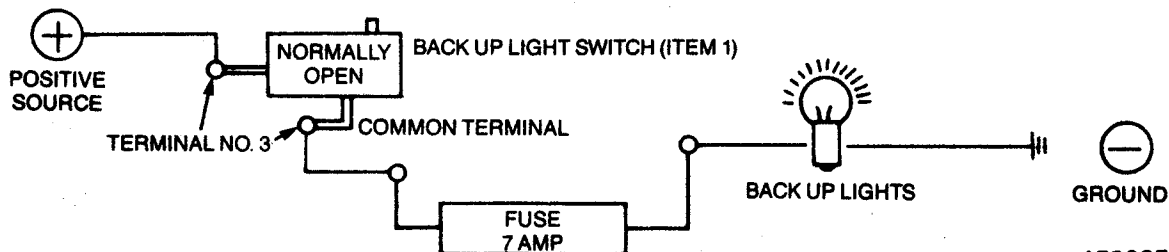

1590050