

NERF BAR INSTALLATION INSTRUCTIONS **92-14 Ford E-Series**

Please read before beginning

- *Stainless steel hardware may bind together when tightening—It is recommended that you apply an anti-seize assembly lubricant to the threads of each bolt before assembly*
- *This installation requires two people*



Required tools

- Drill and drill bits (1/4", 5/16", 3/8")
- Standard wrench set
- Center punch or scribing tool
- Leveling tool
- C-clamps

Included hardware

Quantity

- | | |
|--|----|
| • 70008 - 1/4-20 Nylock Nuts SS | 8 |
| • 70009 - 1/4 x 5/8 Washer SS (.03" Thick) | 8 |
| • 70230 - 1/4-20 x 4 1/2" Hex Bolt H/C SS | 4 |
| • 70039 - 1/4 x 7/8" Washer SS Fender | 12 |
| • 70060 - 1/4-20 x 1" Bolt, Button Head, Socket Cap, SS, | 8 |
| • 70194 - Tapped-Hole No-Slip Clip-on Nut, 1/4"-20 | 4 |
| • 70024 – 3/8-16 Nylock Nut, SS | 16 |
| • 70028 – 3/8" Flat Washer, SS | 32 |
| • 70029 – 3/8-16 x 1 1/4" Hex Head Bolt, SS | 16 |
| • Antiseize Packet, 2g | 1 |

Included Parts/Subassemblies

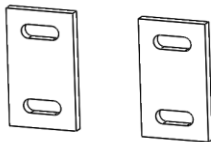

x2
 Aluminum Backing Plates

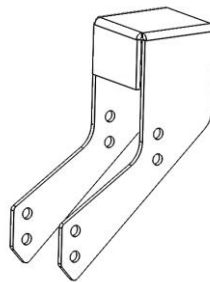

x2
 Front Bracket

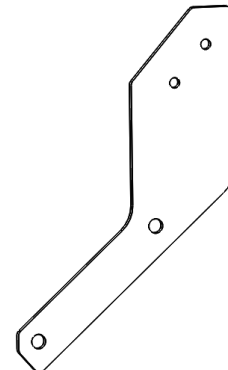

x4
 Rear Bracket



Assembly Instructions

1. Assemble the front nerf bar brackets to the main nerf bar assembly using the top set of holes on each bracket, as shown in Figure 1. Use the 3/8-16 x 1 1/4" bolts provided in the hardware kit.

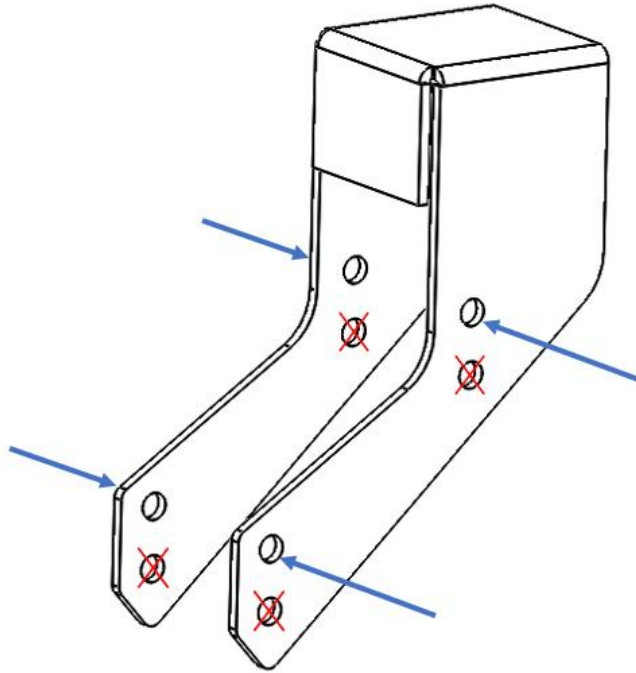

Figure 1. Bolt the top holes of the front bracket to the nerf bar assembly.

2. Bolt the rear nerf bar brackets to the nerf bar assembly, as shown in Figure 2.

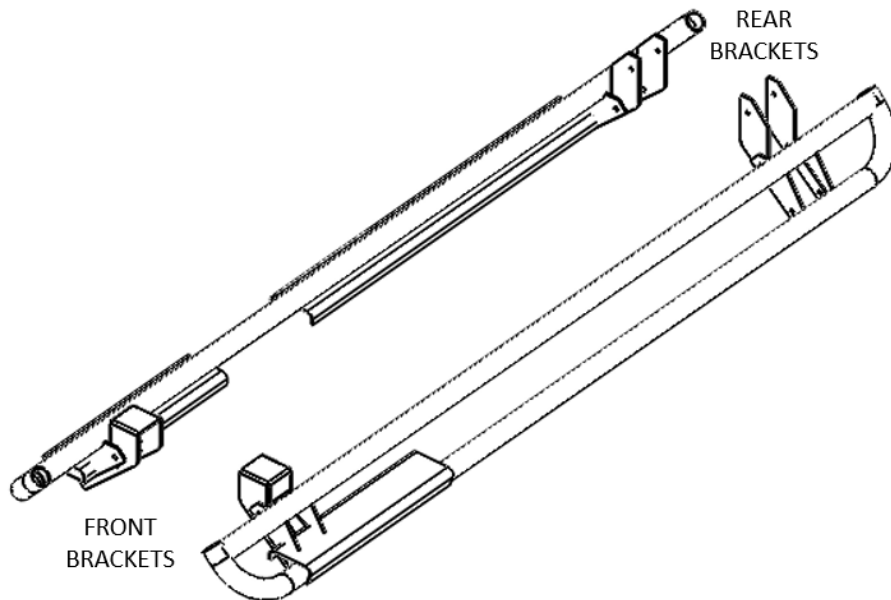

Figure 2. Correct orientation of front and rear brackets assembled.



3. Open the front door and pull up on the plastic step covers to see painted metal underneath
4. Note the wires that cross because you will be drilling through into this space
5. Lie on your back and hold the nerf bar up against the underside of the van so that the flat mounting surface in the front is held flat against the bottom face of the step—The two rear flanges should also be fitted on either side of the body
6. Have your partner check to see if the nerf bar step is level
7. Mark through the top hole on the rear flange to the body using a punch or scribe
8. Remove the nerf bar
9. Drill the hole for the back flange using a 1/4" drill bit so that one bolt may go all the way through
10. Put the nerf bar back and insert the 5" bolt through the hole you just drilled
11. On the front bracket hold the nerf bar up so the flat mounting surface is flat against the bottom of the van step; drill up and through the step ensuring that you have enough room for both holes that are in the backing plate and being careful of the wiring on the top of the step—drill the second hole from the top down using the backing plate as a guide.
12. Bolt down through the step and bracket plate using the 1/4"x 1" bolts, two 1/4" washers per bolt, and 1/4" nylock nuts
13. Drill and bolt a second hole through the rear flange and body mount
14. Again, put the 1/4"x 5" bolt through the hole with the washers on either side and a nylock nut
15. Fit step cover back on
16. Additional support
 - a. Drill a 1/4" hole, through the pinch weld and the back side of the Nerf Bar Bracket (Front or rear, passenger or driver side).
 - b. Place the Tapped-Hole No-Slip Clip-on Nut, 1/4"-20 over the Pinch Weld.
 - c. Using the 1/4" bolt with a washer, thread the bolt through the hole from the inside of the nerf bar to the Tapped-Hole No-Slip Clip-on Nut on the Pinch Weld.
17. Repeat the process for the other 3 mounts.