

REKUDO

1972-1993 D100 Drop Bracket kit Installation Instructions RK200-09

Included Hardware:

Before beginning installation, verify that all components are present.

Description	Qty
D100 Drop Bracket Lower RHS	1
D100 Drop Bracket Lower LHS	1
Drop U Bolt	4
Drop Bracket Shock Stud	2
D100 Upper Drop Brackets	2
5/8"-18 Locknuts	8
5/8" Washers	8
1/2"-20 Lock Nuts	2
1/2" Washers	2
7/16"-20 Lock Nuts	2
7/16" Washers	2
Rekudo Toolbox Sticker	1

Installation Notes:

IMPORTANT! Before beginning installation, it is **CRITICAL** to re-weld the factory leaf spring perches. The stock welds do not have adequate penetration or coverage to support the extra load from a drop bracket. Below is the damage that can occur without reinforcing the welds.



Figure 1

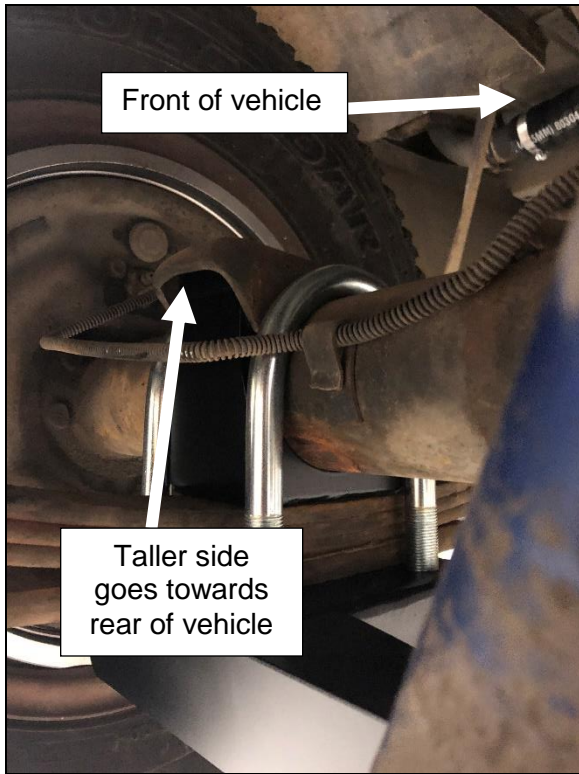

Figure 2

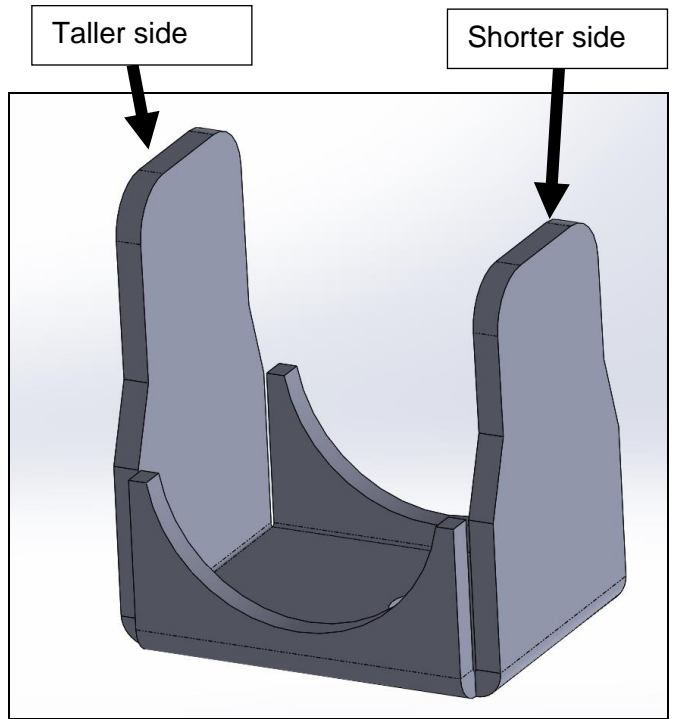

Figure 3



Figure 4

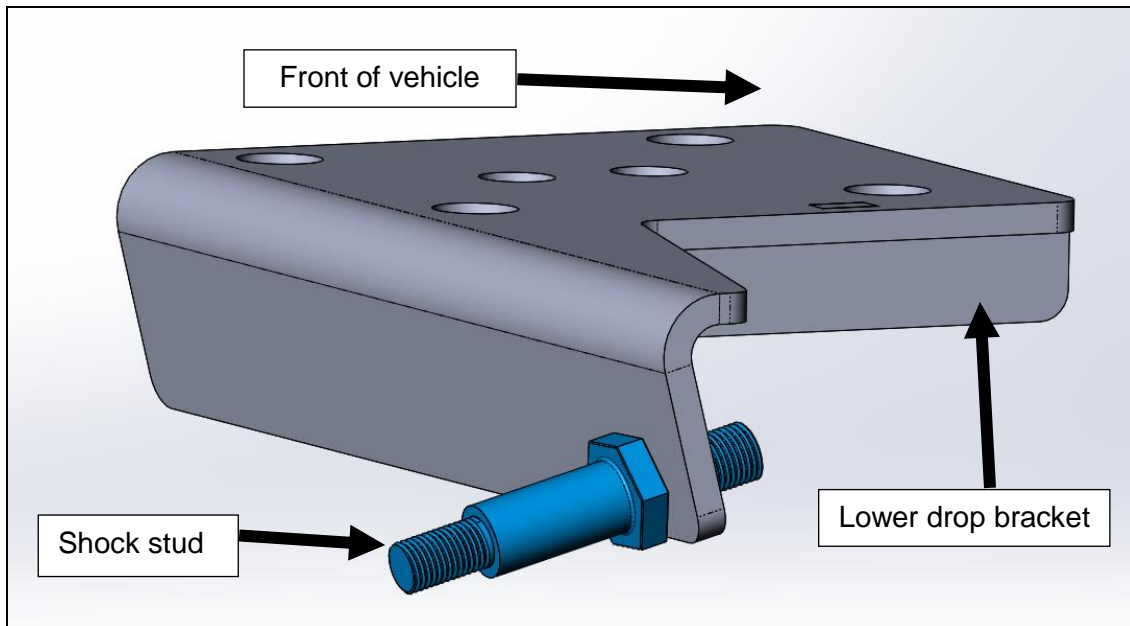

Figure 5

1. With the rear axle supported and located above the leaf springs, install upper brackets as shown in **(Figures 2 & 3)**, with the taller side facing towards the rear of the vehicle. Note that both upper brackets are identical.
2. Slip U bolts over axle and loosely install lower mount brackets with supplied 5/8th washers and locknuts. Note that the shock mount hole should be positioned inboard, closest to the driveshaft, and the shock stud should be installed pointing towards the rear of the vehicle **(Figure 4)**. Lower brackets are side specific.
3. Torque U bolts to 110ft/lbs in 3 steps evenly in a square pattern.
4. Install shock stud by inserting the 1/2" threaded portion thru the lower bracket hold, making sure the stud protrudes from the rear side of the bracket **(Figure 5)**. Install 1/2" washer and nyloc nut, then torque to 60ft/lbs. Repeat on other side.
5. Slide shock over stud, then install 7/16th" washer and locknut on the end of the stud. Torque to 20ft/lbs. Repeat on other side.
6. Recheck after all torque values after 25 miles.

**REKUDO Technical Support:
1-866-464-6553**

**199R12143
Revision Date: 12-9-20**