



**DDX6.9** | 6.9" DOUBLE DIN MULTIMEDIA DVD RECEIVER WITH  
MIRROR-LINK FOR IOS & ANDROID BT/AUX/USB/SD/AM/FM

**OWNER'S MANUAL**

**#WELIKEITLOUD**    



## >> IMPORTANT NOTICE & PRECAUTIONS

Thank you for using our DS18 multi-media player! To operate the unit correctly, please read the operation manual carefully before using. Keep this operation manual for further reference.

The unit is designed only for DC 12V negative ground operation system. Make sure your vehicle is connected to DC 12V negative ground electrical system. Be sure to connect the speaker(-) leads to the speaker (-) terminal. Never connect the left and right channel speaker wires together or to the vehicle body.

The normal temperature for operation is between -20 and 60 degree Celsius. Do not work in extreme high or low temperature and block vents or radiator panels of the unit, blocking them will cause heat to build up inside the unit and may cause damage or fire.

This unit can play the multi-media files: RMVB / MPEG 4 / DivX / AVI / 1080p / MP3 / WMA/ JPEG.

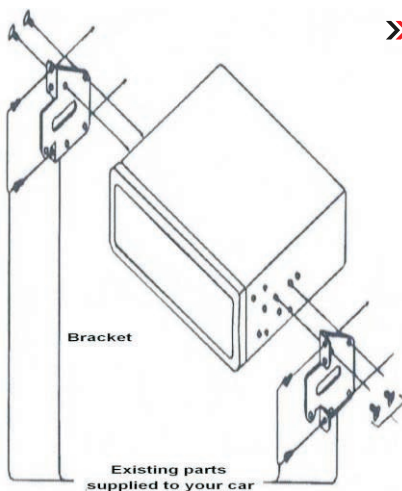

## >> INSTALLATION

- Installation varies on type of cars and supplied parts
- Store small articles in places not accessible to children
- Install only with the supplied screws
- Installation of unit by professional technician is strongly recommended

## >> REMARKS

Mounting brackets and screws are the parts that supplied in your car and not provided in this unit.

BACK OF MAIN UNIT

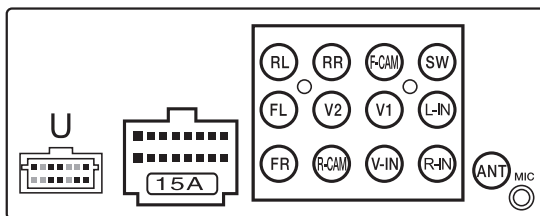

>> REMARKS

Due to the law of some countries, video playback is not allowed, during driving. To allow video playback during driving, the brown wire (brake) should be connected to ground (b-) of the car battery.

Portion		colour	Connection
Connecting Socket	Power	Red	Ignition switch(B+)
		Black(Thick )	Ground (B-)
		Yellow	Memory back up (B+)
		White	Front left speaker(+)
		White/Black	Front left speaker(-)
		Grey	Front right speaker(+)
		Grey /Black	Front right speaker(-)
		Green	Rear left speaker(+)
		Green/Black	Rear left speaker(-)
		Purple	Rear right speaker(+)
		Purple/Black	Rear right speaker(-)
		Blue	Auto antenna(B+)
		Pink	Reverse Lamp(B+)
		Pink/Black	Front Camera Output (B+)
		Grey	Steering wheel control(1)
		Green	Steering wheel control(2)
Audio output RCA	Black( Thin )		Steering wheel control(Ground)
	Orange		Illumination Detection input (B+)
	Brown		Hand Brake Detection (B-)
	Blue/white		Remote Out (B+)
	USB		USB wire Extension
	MIC		External MIC input
	ANT		Radio antenna
	SW	Green	Sub-woofer Pre-Output
	RL	White	Rear left Pre-Output
	RR	Red	Rear right Pre-Output
Audio input RCA	FL	White	Front left Pre-Output
	FR	Red	Front right Pre-Output
	L-IN	White	Auxiliary left Audio input
Video output RCA	R-IN	Red	Auxiliary Right Audio input
	V1&V2	Yellow	Video output
Video input RCA	R-CAM	Yellow	Reverse Camera input
	V-IN	Yellow	Video input
	F-CAM	Yellow	Front camera input



NO.	FUNCTION	OPERATIONS & CONTROLS
1	▲ / EJECT	Press to eject from the disc slot (when a disc has been inserted).
2	MIC	For voice reception under BT operation
3	IR	Remote control sensor for signal reception from remote handset.
4	🏠	Press to shift between MAIN MENU & current operation mode.
5	🌀	For rotary control version, rotate to adjust sound output level. When the unit is turned off, press to turn on the unit. When the unit is turned on, press & hold shortly to turn off unit.
6	>>/<<	<u>Radio Mode</u> Press repeatedly to fine tune the radio frequency upward or downward. Press & hold shortly to tune the radio frequency to the upward or downward station for broadcasting. <u>Disc / USB / SD Input Mode / Bluetooth Mode</u> Press repeatedly to shift track upward or downward for playback. Each time press & hold shortly to activate various fast forward/rewind speeds for playback. (Note: Fast forward or fast rewind is not available at Bluetooth mode & picture playback mode)
7	RST	Press with a pointed object (such as a ball point) to reset the unit to its initial setting by the factory (default stage).
8	USB	Insert USB device to this slot for digital files playback

NO.	FUNCTION	OPERATIONS & CONTROLS
9	AUX	Insert an external device to this jack in order to have sound output of that external device through the unit.
10	MICRO SD	Insert micro SD card to this port for digital files playback
11	DISC SLOT	Insert or remove disc from this disc slot,
12	TFT SCREEN	It shows the status of operation on the unit. This screen is also a touch-screen display - tap the screen softly for different operations of unit (refer to other parts of this manual for operation details).

**» NOTE** Printing and symbols on the above may be varied from the exact main unit. Referred to the main unit for exact functions and features that applied. User is highly recommended to use the touch screen control to operate.

## » REMOTE HANDSET GENERAL OPERATIONS

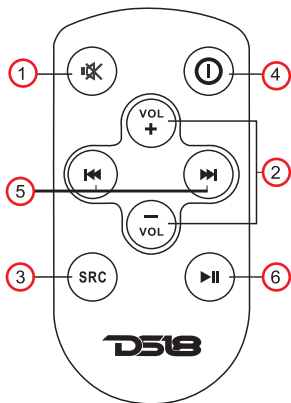

NO.	FUNCTION	OPERATIONS & CONTROLS
1	Mute	Sound mute control.
2	VOL+/VOL-	Adjust sound output level.
3	SRC	Press repeatedly to select the desired mode for operation.
4	Power	Press to turn on the unit or turn off the unit.
5	Previous/Next	<u>Radio Mode</u> Press to tune the radio frequency upward or downward and stop for broadcasting when a station received. <u>Media Playback Mode</u> Press to shift track upward or downward for playback.
6	Play/Pause	Press to pause, resume or start playback.

### BATTERY REPLACEMENT

Refer to the back of remote handset for details on how to replace the battery. Replace only with the same or equivalent type of battery.

### BATTERY DISPOSAL

Attention should be drawn to the environmental aspects of used battery disposal. Battery shall not be exposed to excessive heat such as sunshine, fire or the like. Danger of explosion if is incorrectly placed.

**» REMARKS** Depends on the input devices & playback media files, operation may be varied or not available for operation.

## MAIN MENU

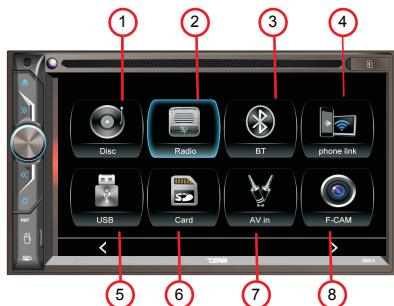

## MAIN MENU

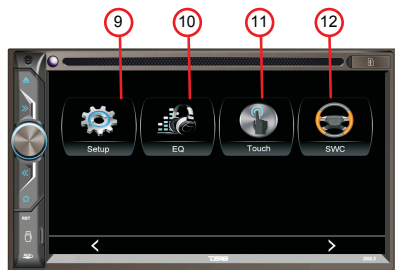

## NO.

## OPERATIONS &amp; CONTROLS

- ① Touch to start disc input operation (when a disc inserted).
- ② Touch to start radio operation (when the radio antenna connected).
- ③ Touch to start BT operation (when mobile phone connected).
- ④ Touch to start mobile phone mirror linking operation (when the mobile phone connected to the front usb port).
- ⑤ Touch to start USB input operation (when an USB device inserted).
- ⑥ Touch to start SD card input operation (when a micro SD card inserted).
- ⑦ Touch to start auxiliary input operation (when an auxiliary device inserted).
- ⑧ Touch to start viewing front camera (when connected to front camera and pink/black wire).
- ⑨ Touch to activate SYSTEM SETUP MENU on screen to have various setup of the unit.
- ⑩ Touch to activate audio & visual setting for various audio & visual setup.
- ⑪ Touch correction (when the machine touch position is wrong).
- ⑫ Touch to activate Steering Wheel Control operation.

## » ON SCREEN - RADIO OPERATION

in MAIN MENU, touch  to shift to radio mode

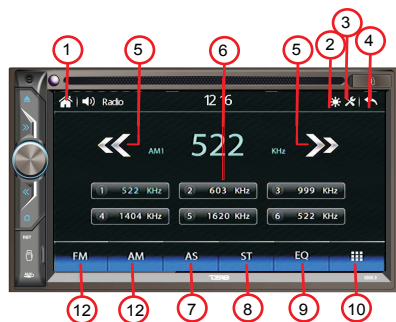
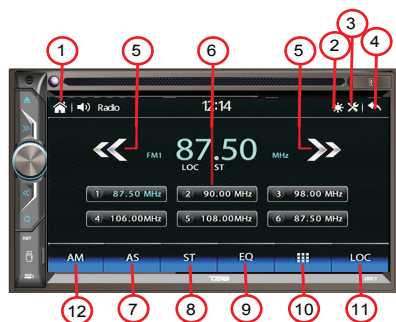

## NO. OPERATIONS & CONTROLS

- 1 Touch to shift to MAIN MENU for selection of various operation and setup.
- 2 Touch repeatedly to select brightness of screen or turn off the screen. Turn off of screen is available under headlamp detection at OFF mode. When the screen is off, touch any portion of the screen to turn it on again.
- 3 Touch to activate audio & visual setting for various audio & visual setup.
- 4 Touch to shift to previous mode.
- 5 Touch to turn frequency upward or downward and stop for broadcasting when a station received. Touch & hold repeatedly to fine tune radio frequency upward or downward.
- 6 This shows the preset memory stations.
- 7 Touch any of the preset memory station to have broadcasting of relative station. Touch & hold shortly on any one of the preset memory station, the current broadcasting station/frequency will be stored in the respective preset memory station.
- 8 Touch to start searching the radio frequency & storing the strongest signal stations into memory. Touch to select stereo (ST) or mono mode at FM radio band. When stereo signal received, stereo indicator will be appeared on screen and this is no indicator for mono signal.



**NO. OPERATIONS & CONTROLS**

- ⑨ Touch to activate EQ operation.
- ⑩ Touch to input the exact frequency which users wants.
- ⑪ Touch to select local (LOC) setting for reception of strong signal stations and a distant setting for reception of weak stations at FM radio band. When local (LOC) setting is selected, LOC will be appeared on screen and this is no indication for distant setting.
- ⑫ Touch to select AM/FM radio band.

## &gt;&gt; ON SCREEN - DISC OPERATION

**NO. OPERATIONS & CONTROLS**

- ① At DVD playback mode, touch to show the title of DVD on screen. (Note: Depended on the DVD, this function may not be operated). At VCD playback mode, touch shift PBC on or off. At PBC on mode, touch to start playback at the beginning in sequence order. At media playback mode, touch to activate PLAYLIST / FOLDER PLAYLIST (available for input device recorded with folder) to select folder / track for playback.
- ② Touch to shift to next or previous track for playback. At video playback mode, touch & hold shortly to activate fast forward or fast rewinding mode. At this mode, touch repeatedly to select various speed on fast forward or fast rewind.
- ③ Touch to start, pause or resume playback.
- ④ Touch repeatedly to select repeat playback mode.
- ⑤ Touch to turn on or off of random playback of the input device.

## >> ON SCREEN - BT OPERATION

in MAIN MENU, touch  to shift to BT mode

### LINK UP WITH MOBILE PHONE

To link up BT connection with the mobile phone, take your phone and follow the steps:

- Set the mobile phone on BT state
- Start to search new device
- After searched, new device (DDX6.9) searched out, confirm the search
- In case of need, input default code "0000" or "8888" in the mobile phone
- At the same time, BT icon & BT DEVICES MENU appeared on screen
- Connection succeeded and you can start using BT function.

### NO. OPERATIONS & CONTROLS

- 1 Touch **BT Call** to dial out numbers of phone.
- 2 Touch **BT Phonebook** to show the phone book of the connected mobile phone.
- 3 Touch to shift to **BT Call Log** to show the record on incoming calls / dial out numbers / missing calls of the connected phone.
- 4 Touch to shift to **BT MUSIC** for transmission of music playback from the connected mobile phone.

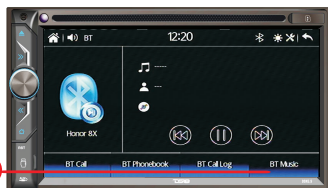
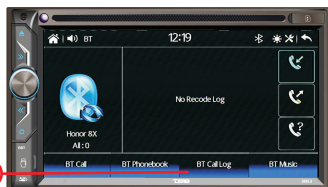

## » ON SCREEN - MOBILE PHONE LINKING OPERATION

in MAIN MENU, touch  to shift to mobile phone linking mode



For iOS devices (supported iPhone 5 to iPhone XS), mobile phone linking operation will start automatically without any setting. Mirror linking appeared on the screen.

For Android devices, when the phone is connected at the first time, see photo appeared on screen.

Scan the QR code by using the connected android phone.

Follow the instruction of the connected phone & download "AUTOLINK" application from Google Play Store or Amazon Site.

Open "AUTOLINK" application after download, mirror linking appeared on screen and mobile phone operation can be started and controlled by touching screen of the unit.

### IMPORTANT NOTICE ON MOBILE PHONE LINKING OPERATION

- 1 Support mirror link: iOS phone is supported from iPhone 5 to iPhone XS and Android phones from 5.0 to upper.
- 2 USB cable should be used to connect the phone to the front usb slot of the head unit.
- 3 In case connecting failed, CONNECT FAILURE MENU appeared on screen. Refer to its detail and USB DEBUG MENU, follow the steps in order to have set up of the phone (USB debug).
- 4 Phone set up will be varied from different phones. Refer to the operation method of the phone for details (usually at settings mode > developer options > USB debugging).
- 5 Depends on the connected smart phone, operation & setting may be varied.

## >> ON SCREEN - USB/SD CARD INPUT OPERATION

in MAIN MENU, touch  /  to shift to multi-media playback mode

Playback will start automatically. Depends on the input device and playback media, touch on screen (at music playback, touch repeatedly on screen) to show various playback menus for operation.

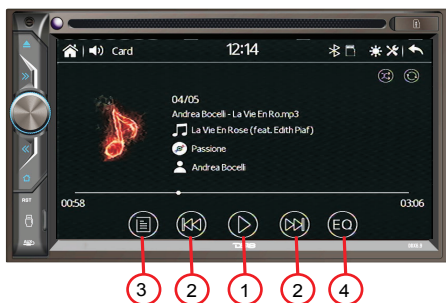
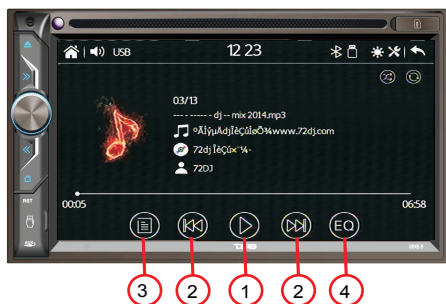

### NO. OPERATIONS & CONTROLS

- ① Touch to start, pause or resume playback.
- ② Touch to shift to next or previous track for playback. At video playback mode, touch & hold shortly to activate fast forward or fast rewind mode. At this mode, touch repeatedly to select various speed on fast forward or fast rewind.
- ③ At the media playback mode, touch to activate **PLAYLIST / FOLDER PLAYLIST** (available for input device recorded with folder) to select folder / track for playback.
- ④ Touch to activate EQ operation.

## » ON SCREEN - MOBILE PHONE LINKING OPERATION

in MAIN MENU, touch  to shift to various setup selection of the unit.

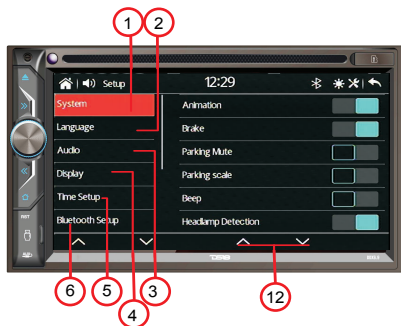

### NO. OPERATIONS & CONTROLS

- 1 Touch to shift to **System SETUP MENU** for various system setting.
- 2 Touch to shift to **Language SETUP MENU** for various language setting.
- 3 Touch to shift to **Audio SETUP MENU** for various audio setting.
- 4 Touch to shift to **Display SETUP MENU** for various visual setting.
- 5 Touch to shift to **Time SETUP MENU** for calendar & clock setting.
- 6 Touch to shift to **BT SETUP MENU** for various BT setting.
- 7 Touch to shift to **Phone link SETUP MENU** for various phone link setting.
- 8 Touch to shift to **Other SETUP MENU** to select the area located and for various illumination backlight setting.
- 9 Touch to shift to **Steering Wheel SETUP MENU** for steering wheel control setting.
- 10 Touch to shift to **Factory SETUP MENU** for more deeper setting.
- 11 Touch to shift to **Version SETUP MENU** to show details of the unit.
- 12 Touch repeatedly to tune the upward or downward manually

## » ON SCREEN - AUXILIARY INPUT OPERATION

in MAIN MENU, touch 

To shift to auxiliary input operation (provided an auxiliary video device had been connected).

At auxiliary input operation, touch any portion of screen to activate **AV INPUT MENU** for operation.



## » ON SCREEN - SWC OPERATION

in MAIN MENU, touch  To shift to activate **SWC STUDY MENU** for steering wheel control.

**Steps for learning & setting:**

- Touch any control key on screen
- Press & hold the respective control of the steering wheel of the car
- The unit starts learning and once completed, indicator appears on screen
- Follow the above steps to set for all other controls
- When completed, press "Save" to confirm the setting
- Press "Reset" to cancel the setting



## » ON SCREEN - FRONT CAMERA INPUT OPERATION

in MAIN MENU, touch 

To shift to front camera viewing (provided front camera and the pink/black wires connected).

At front camera viewing mode, touch any portion of screen to activate **FRONT CAMERA INPUT MENU** for operation.



## >> APP CONTROL

Download the APP: **DS18 DDXRC** in the Google Play for your Android Device

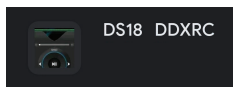

After the APP is intalled, make sure the Radio is ON, now you can open the APP in your phone, the setup screen is the first screen that you will see:

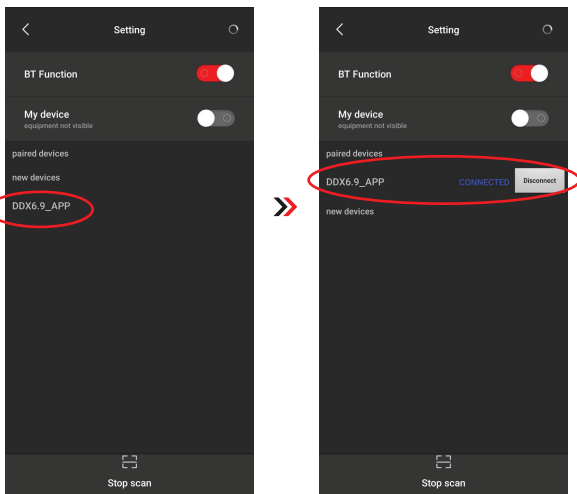

The Radio must appear in the list, tap it to connect it to the app.

**Now it is ready to use!**

The main screen is showing all the basic functions to control your DS18 Radio:

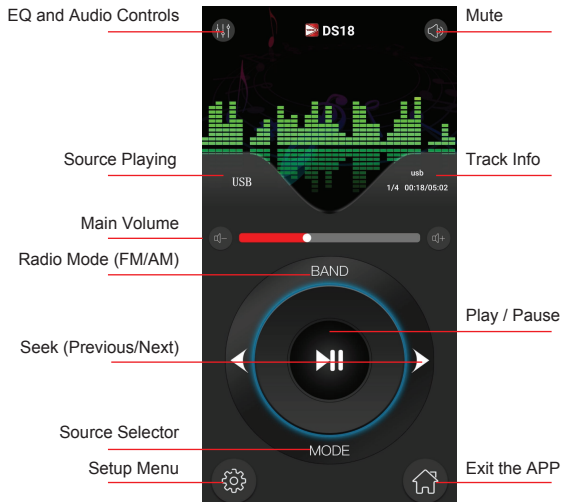

EQ and Audio Control Menu:

You can adjust the Bass, Treble, Balance and Fader.

Reset Button make all this controls go back to Cero or Center position.

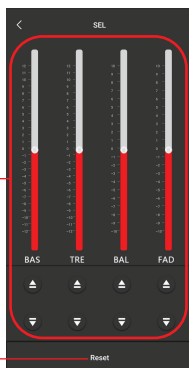



**General:**

Rated power source:  
Maximum Current Consumption:  
Dimensions (W x H x D):

14.4V DC (10.8V to 15V operation)  
10 Amp  
Chassis: 178mm x 100mm x 165mm  
Bezel frame: 170mm x 96mm x 5mm  
Weight: 1.52 Kg

**Display:**

Screen Size / Aspect Ratio:  
Pixels:  
Display Type:  
Temperature Operation:

6.9 inch / Wide 16:9  
1024 x 600  
TFT / WSVGA / Capacitive Touch Screen  
-20°C to +60°C (14°F to 140°F)

**Audio:**

Maximum Power Output:  
Continuous Power Output:  
Pre-output Level:  
Equalizer:

40W x 4 Ch / 4 ohm  
15W x 4 Ch / 4 ohm  
4.5 Volts (Front, Rear) 7 Volts (Subwoofer)  
16 bands (35Hz, 60Hz, 80Hz, 120Hz, 160Hz,  
250Hz, 320Hz, 400Hz, 600Hz, 800Hz, 1KHz, 3KHz,  
5KHz, 8KHz, 12.5KHz, 16KHz)

Gain:  
Audio Control:

+/- 12dB  
Volume / Balance / Fader / Loudness

**Tuner:**

Frequency Range:  
Presets Memory:  
Region:

FM: 87.5 ~ 107.9 KHz AM: 530 ~ 1710 KHz  
30 Stations (18 FM/12 AM)  
Selectable (USA, Latin, Japan, Asia, Europe,  
OIRT, Australia, Mid-East)  
LOC (On/Off) / ST (On/Off)

Sensitivity Adjustment:

**DVD Player:**

Format Files Supported:  
Usable Discs:  
Region Number:

DVD-V, VCD, SVCD, MP3, WMA, DivX, MPG4  
CD, CD-R, CD-RW, DVD-R, DVD-RW, DVD-RDL  
1 / Multi Region Selectable

**USB / SD Player:**

Type / Class:  
Format Files Supported:  
Resolution Supported:  
Memory Size Reader:  
Max Current Supply:  
Number of USB Ports:

V1.1 / V2.0 / MSC / MTP / FAT16 / FAT32 / NTFS  
RMVB, MPG4, AVI, MP3, WMA, JPEG, DivX  
1080P Video  
up to 64 Gb  
1.5 Amp (USB)  
2 (1 x Front, 1 x Rear)

**Connectivity:**

Bluetooth Version / Services:  
Camera Input:  
Video Output:  
A/V Aux Input:

V4.1 / Audio Streaming / Hands Free calls  
RCA Analog Video up to HD 720p (Front/Rear)  
Dual RCA (1 Volt/75 ohm)  
Rear RCA Audio and Video /  
Front 3.5mm Jack Stereo Audio  
3.5mm Jack external MIC Input  
Frontal IR Receptor / Wired (3.5mm jack) Input

Microphone:  
Remote Control:

#### No power

Check and make sure the connecting wires are connected correctly

- Check whether the fuse is blown. Replace with the proper value fuse if necessary.

#### No sound

- Check and make sure the speaker wires are connected correctly.

#### No picture

- Check whether the video wire is connected to the video device.

#### Unit hang -up

- Press the RESET button to reset the unit to its default stage.

#### No function when pressing the buttons or TFT screen

- Press the RESET button to reset the unit to its default stage.

#### Poor effect or unable to receive radio

- Check whether the radio antenna is inserted or properly connected.
- Antenna may not be the proper length. Make sure the antenna is fully extended.
- Antenna may be poorly grounded. Check and make sure the antenna is properly grounded.

#### Stereo cannot be received under radio mode

- Tune the radio frequency accurately.
- The broadcasting signal is too weak, set the mode to MONO.

#### Abnormal moving, skipping or sound during playback

- The disc is dirty or damaged. Wipe the disc with a dry soft cloth or replace a new disc.

#### Remote handset does not work

- Replace new battery of the remote handset.
- Point the remote handset directly at the remote sensor of the main unit.
- Clean the surface of the remote sensor.

#### Bluetooth not operated

- check the devices are linked up correctly.

#### Disc insered but cannot play

- Check whether the disc inserted upside down.
- Check whether the disc is dirty or badly cracked.
- Lens is dirty. Clean lens by using the lens clean disc.





**DDX6.9** | 6.9" DOUBLE DIN MULTIMEDIA DVD RECEIVER WITH  
MIRROR-LINK FOR IOS & ANDROID BT/AUX/USB/SD/AM/FM

# OWNER'S MANUAL

**DS18.COM**

