



J106737
J106738

LED Hood Light Bar Bracket Jeep Wrangler JK 2007-CURRENT

INSTALLATION INSTRUCTIONS:

1. Locate the 2pcs Torx bolts that attach the hinge to the hood.

Use the T-50 Torx socket to carefully remove the bolts from one side only (you can start with passenger or driver side).

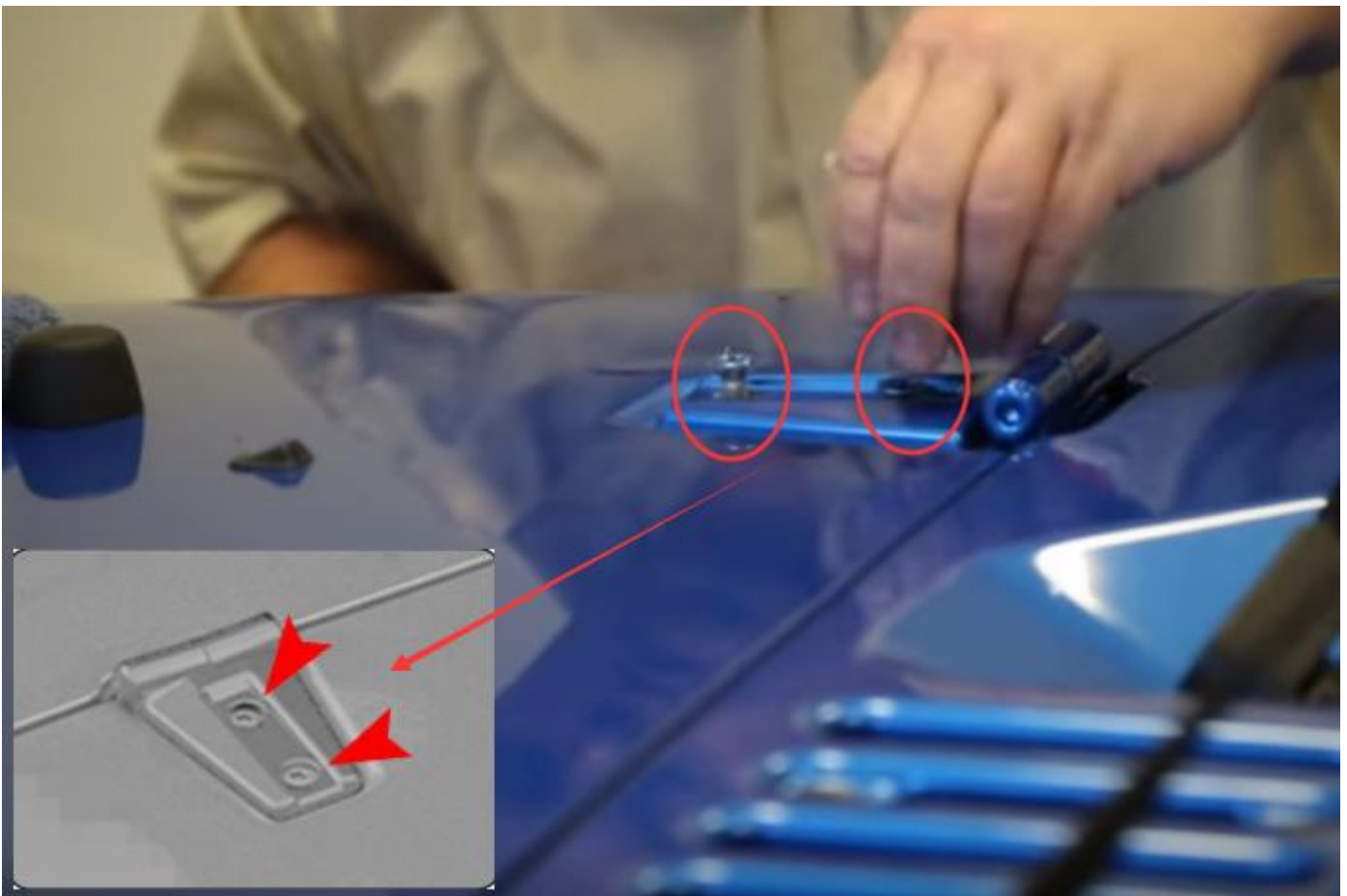

2. Place one of the supplied steel spacers over each hole on top of the hinge, then sit the bracket on top and secure by screwing in the supplied hex bolts + flat washers with the 13mm Socket.

3. Repeat steps 1-2 for other side;

4. Install light bar and harness per supplied instructions;