



P.O. Box 1719
 Corona, CA 92878
 Support: 951-493-7100
 www.aFeFilters.com

Intake Kit Installation Instructions: 2006-2007 BMW 550i/650ci E60/E63 V8-4.8L

Kit Part #	51-11142		Tools Required:	Part List:	2 Spacers, nylon
	54-11142				6 Screws, button head
Make:	BMW		5/16" nut driver	1 Air Filter (replacement ProDRY S™ #21-90044 / #24-91021)	1 Nut, M6
			10mm socket w/ extension and ratchet	1 Intake tube	1 Washer, M6
Model	Year	Engine	10mm open/box end wrench	1 Housing	2 Screws MAF Sensor
550i	2006-2007	V8- 4.8L	Flat head/slotted screwdriver	1 Cover, Aluminum	1 MAF Sensor Gasket
650ci	2006-2007	V8- 4.8L	5/32" allen wrench	1 Reducer coupler (05-00020)	1 Adapter, Injection molded
			Torx bit T20	1 Reducer coupler (05-00632)	1 Torx bit, T20
			Torx bit T25	2 Clamp #072	
				2 Clamp #060	



Complete kit with parts.

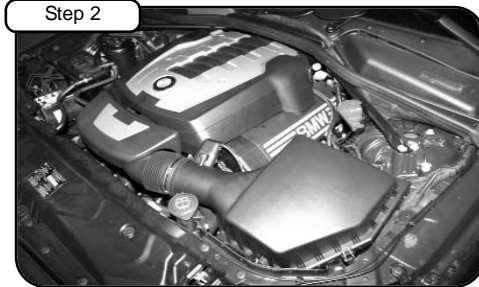

Complete stock intake.

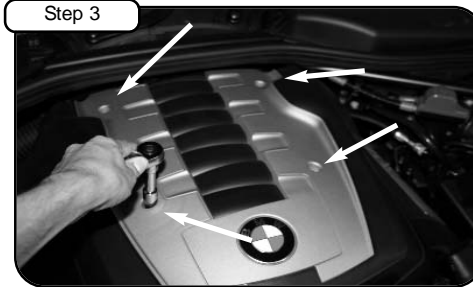

Remove the 4 bolts holding the factory engine cover with 10mm socket w/ ratchet. Remove engine cover.

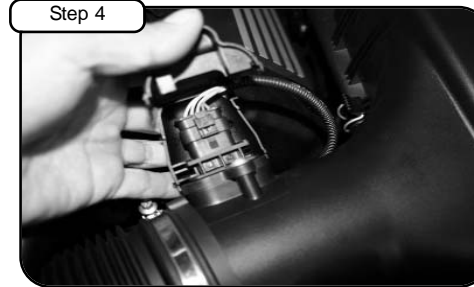

Remove the MAF sensor cover. Disconnect the MAF harness from sensor.



With 1/4" nut driver loosen the OE intake tube from throttle body and airbox. Remove intake tube out of vehicle.

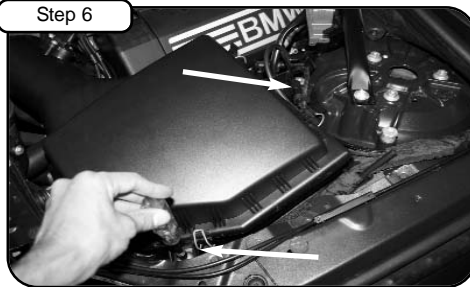

With T25 torx bit, loosen the 2 bolts that hold the OE airbox in place. Carefully remove the airbox out of vehicle.



With provided T20 torx bit loosen the 2 bolts that hold in the MAF sensor. Carefully remove MAF sensor out.

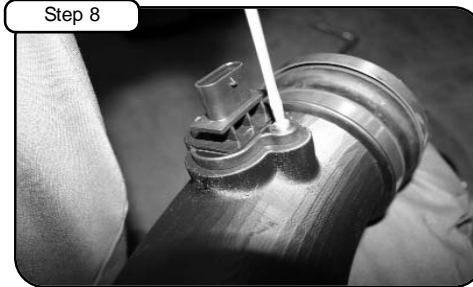

With M4 screws, gasket, and spacers provided, place MAF sensor in to new tube. (make sure gasket is between tube and sensor)



Using a 10mm wrench loosen bolt holding washer fluid reservoir. Place 5 1/2" adapter in to new housing and tighten using button head screws provided with 5/32 allen key. Install housing in to vehicle and re-tighten bolt.



With OE T25 bolt, use to tighten new housing in to place. Tighten at bottom of housing using nut and washer provided with 10mm socket w/ extension.

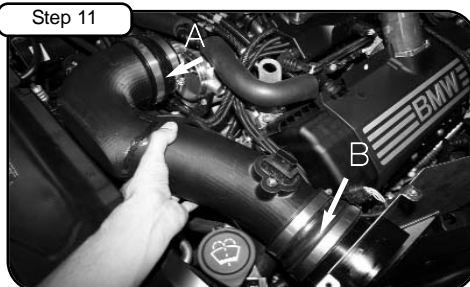

Place couplers with clamps provided on to tube and install new tube in to vehicle.
 A) coupler 05-00020
 B) coupler 05-00632

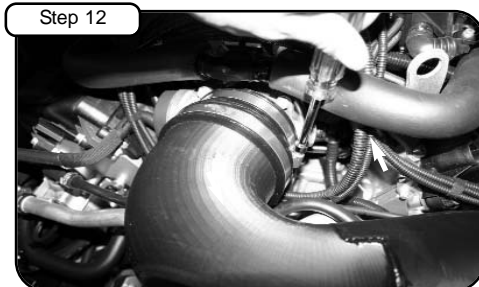

Tighten clamps using 5/16" nut driver.



Re-install OE engine cover.



Place high FLOW filter into housing and tighten using 5/16" nut driver. Install housing cover using the 3 button head screws and tighten using 5/32" allen key.



Your installation is now complete. Check all clamps and hoses periodically. Thank you for choosing aFe!

Note: Filter Cleaning and Re-oiling: When cleaning your aFe filter, be sure to use only aFe's "Restore Kit" (aFe P/N: 90-50001 blue oil aerosol, or aFe P/N: 90-50501 blue squeeze bottle oil). Filter Replacement: PN: 24-91021 (black w/blue media)
 ProDRY S™ cleaning: see cleaning instruction sheet 06-00074 ProDRY S™ P/N 21-90004