



P.O. Box 1719
 Corona, CA 92878
 Support: 951-493-7100
 www.aFeFilters.com

Intake Kit Installation Instructions: '05 -'07 Volkswagen MK V GTI(Rabbit)/JETTA GLI L4-2.0L FSI Turbo Stage 2 Cx

Kit Part #	51/54-11112		Tools Required:	Part List:	1 7/16" Trim seal @ 7" L
Make:	Volkswagen		5/16" nut driver	1 Air Filter Replacement P/N (21-40507 or Pro Dry S™ 21-40507)	1 Clamp, #064
Model	Year	Engine	10mm open/box end wrench	1 Housing, wrinkle black	5 Clamps, #044
GTI(Rabbit)	2005 -2007	L4-2.0L FSI	Pliers/Channel locks	2 Tubes, 2-3/4" (90 degrees)	1 Isolation mount, M6
Jetta GLI	2005 -2007	L4-2.0L FSI	Phillips screw driver	1 Tube, 4" (90 degrees)	1 Washer, wavy M6
			T-20 torx bit	1 Coupling, reducer (4" x 2-3/4")	1 Washer, flat M6
				1 Coupling, straight (2-3/4" x 3")	1 Nut, M6
				1 Coupling, reducer (2-3/4" x 2-1/2")	2 Screws, M4
					1 T-20 torx bit



Complete kit with parts.



Complete stock intake.



With T-20 torx bit, loosen the 2 bolts that hold in OE intake ram air unit and pull away.



Disconnect the MAF harness and unclip the two clips holding in OE intake tube. Pull away OE tube from engine cover.



Carefully grab engine cover firmly, pull up and remove. (This may require some force)

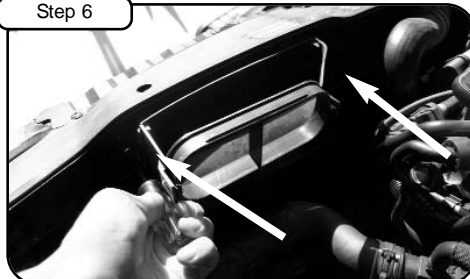

With T-20 torx bit, loosen the two bolts that hold in the OE ram air harness bracket and remove. Save bolts for later use.



With pliers or channel locks, remove clamp off OE intake tube and remove from turbo. Also make sure OE turbo coupler is removed.



Install trim seal to housing and place into vehicle. Tighten using screws from step 6. Use provided M6 isolation mount to tighten housing down in front of battery.



Install MAF sensor into new tube with screws provided and tighten using flat head screwdriver.



Place 2-1/2" coupler side onto turbo with clamps provided and tighten. (Make sure 2-3/4" side is facing up) Install intake tube from step 9.



Place 2-3/4" x 3" straight coupler onto other 90 degree tube and install. Do not tighten.



Place 2-3/4" x 4" reducer coupler on 2-3/4" tube side. Place 4" 90 degree tube onto 4" coupler side. Guide tab on 4" tube into isolation mount.

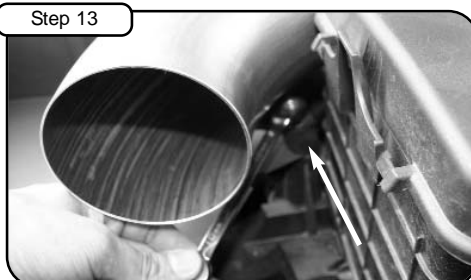

Tighten Isolation mount with M6 nut and washer provided. Make sure tab is on isolation mount. Adjust height and tighten all clamps on intake tubes with 5/16" nut driver.



Install Air Filter and tighten using 5/16" nut driver. (To ensure filter is engaged properly, mark a line 1" from the end of the tube, position filter flange at line and tighten clamp).



Your installation is now complete. Check all clamps and hoses periodically. Thank you for choosing aFe!

Note: Filter Cleaning and Re-oiling: When cleaning your aFe filter, be sure to use only aFe's "Restore Kit" (aFe P/N: 90-50001 blue oil aerosol, or aFe P/N: 90-50501 blue squeeze bottle oil).
 Filter Replacement P/N: 24-40507 (black w/blue media) Pro Dry S™ P/N: 21-40507 (black w/white media) Pro Dry S™ cleaning: see cleaning instruction sheet 06-00074