

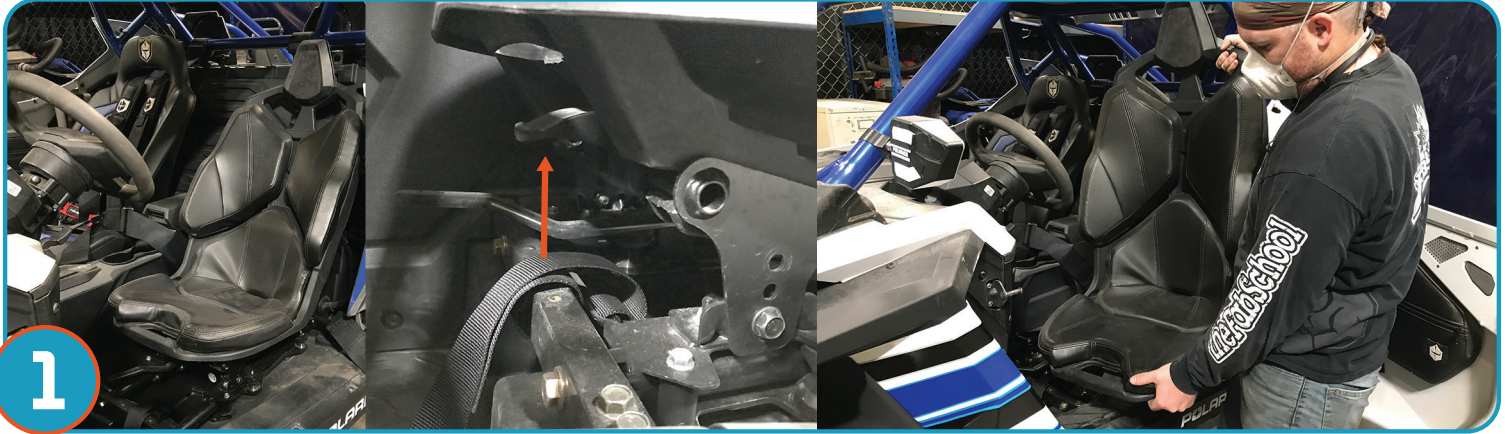

G-FORCE PRO SEAT INSTALL INSTRUCTIONS (P199S193)

Note: For further information on installation instructions please visit our website www.proarmor.com



Remove stock seat by lifting the lever located under the front base of stock seat. Tilt headrest, then base forward to extract seat from base.

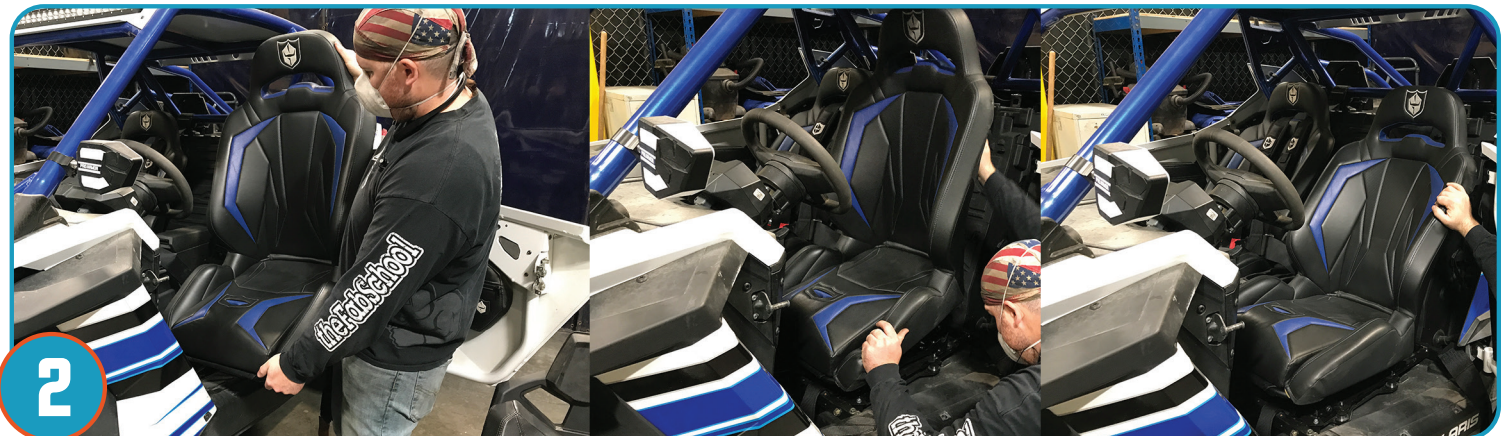

Place the G-Force Pro Seat, sliding the seat cushion in first to catch the seat base, then lowering the seat toward rear of vehicle clicking seat into place.

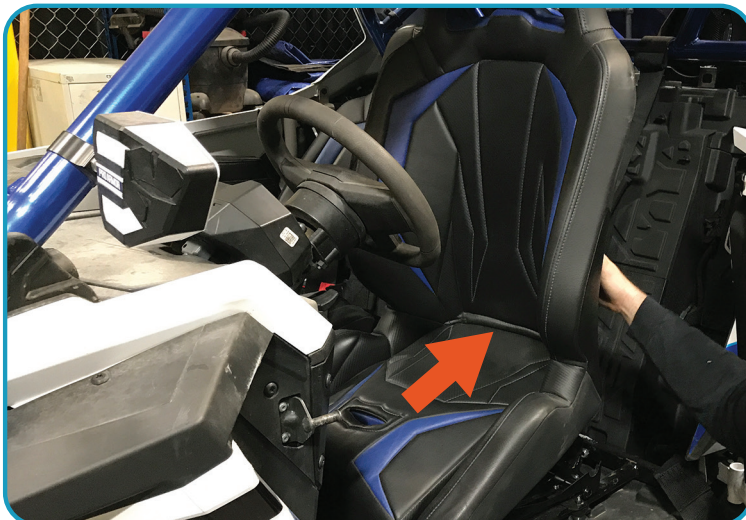

To remove the G-Force Pro seat insert hand at base and press down on the 2 plastic hooks holding the seat in. Lean forward and extract seat from Vehicle.

⚠ WARNING

- **Never** stick hands, head or arms outside of vehicle at any time when it is in motion.
- **Always** wear and use proper safety equipment when using any Pro Armor product.
- Improper use of directions and/or product can result in injury to yourself or damage to your vehicle.
- **Disclaimer please read:** This product is sold without warranty expressed or implied. No warranty or representation is made as to the products ability to protect the user / occupant from any injury or death in any manner of use. The user assumes that risk. The effectiveness of this equipment is directly related to the manner in which it is installed, used, and / or maintained.
Proper installation is solely the responsibility of the installer, and will not be assumed by Pro Armor.
- If you have questions about your installation or are unable able to complete installation, contact Pro Armor Customer Service (888)312-7667 or have an authorized dealer or trained technician, inspect your installation.