

2016+ CAMARO SS

CORSA
PERFORMANCE

Part #: CC0007



IMPORTANT! WARRANTY AND INSTALLATION INSTRUCTIONS

Please Forward All Information to Consumer

Be sure to review the enclosed instructions prior to beginning the installation process. If you have any questions about the enclosed parts or instructions, or if you encounter a problem during installation:

CALL TECHNICAL SUPPORT: 440.891.0999 or 800.486.0999

**TO ACTIVATE YOUR WARRANTY GO TO:
CORSAPERFORMANCE.COM/WARRANTY**

COLOR INSTRUCTIONS ARE AVAILABLE BY PART NUMBER ON: CORSAPERFORMANCE.COM



NEVER work on a hot engine bay.
Allow time for the vehicle to cool.

INSTALL DIFFICULTY



RECOMMENDED TOOLS & SUPPLIES

- 10mm Socket Wrench
- 11/16" Wrench
- 2.5mm Hex Wrench
-

Please take time to read and understand these installation instructions.

CORSA recommends that the installation of this system be performed by a qualified service center or professional installer who has the necessary equipment, tools, and experienced personnel. However, if you decide to perform this installation yourself, the use of an additional person may be required.

WARNING: Never work on a hot engine bay. Allow time for the vehicle to cool.

This warranty does not extend to damaged or defect in the finish of a product or to any product, that in the opinion of CORSA Performance, has been misused, damaged by accident or negligence, altered or modified in any way, faulty installation or installed contrary to CORSA installation instructions, or repaired by an unauthorized service facility.

Full warranty available on www.corsaperformance.com

Please confirm that all parts are present according to the bill of materials before beginning the installation.

If something is missing call Tech Support at 440.891.099 or Toll Free: 1.800.486.0999

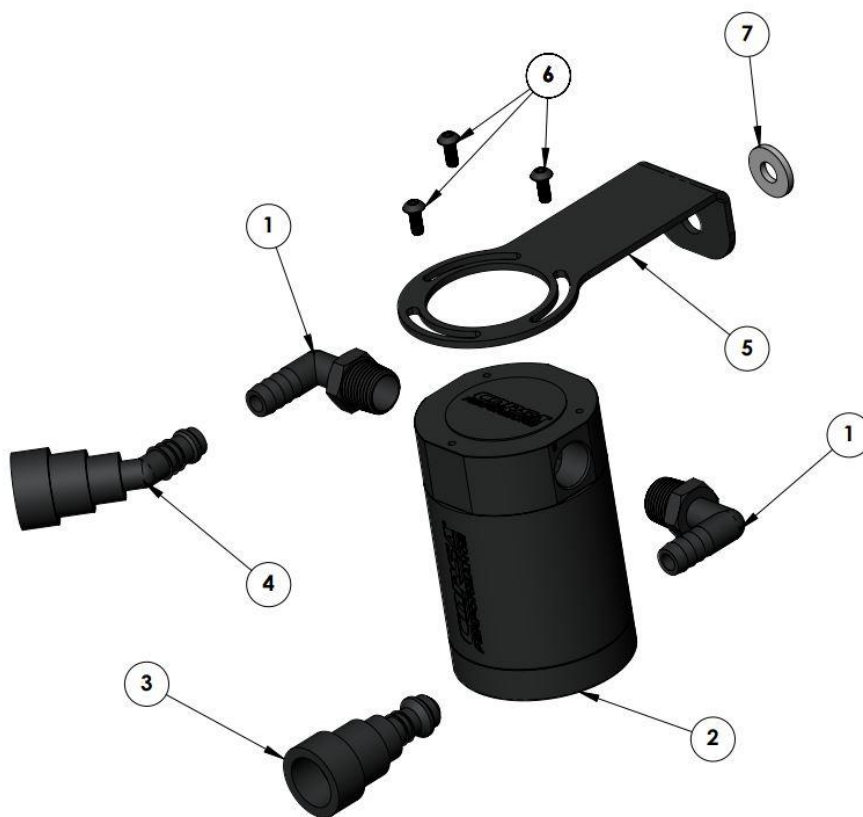

HARDWARE KIT

1. 3/8" NPT Barbed Elbow Fitting	2	4. 10mm Quick Disconnect 45° Elbow Fitting	1	7. Nylon Spacer	1
2. Catch Can Body	1	5. Bracket	1	NOT PICTURED:	
3. 10mm Quick Disconnect Straight Fitting	1	6. 4mm Hex Screws	3	8. 3/8" Hose A	22"
				9. 3/8" Hose B	23"

REMOVAL INSTRUCTIONS

FACTORY PCV LINE



1. Unclip the fluid line running across the top of the engine cover. Remove the 2 side engine covers by pulling up and releasing them from the press fit tabs.

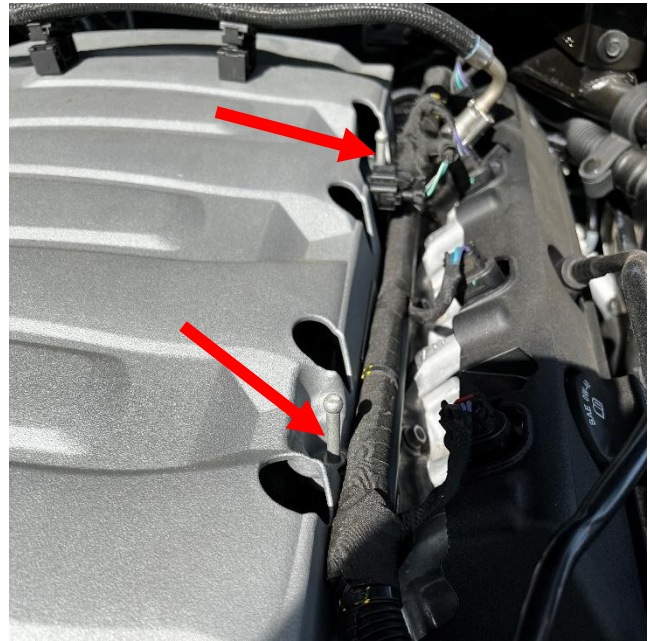

2. Using a 10mm socket, remove the 4 bolts that hold the central engine cover (2 on either side).

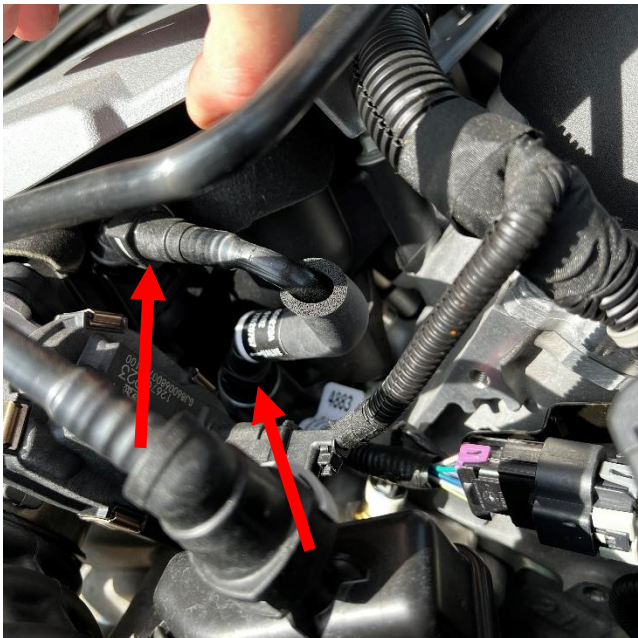

3. Locate the PCV line on the driver's side of the engine just behind the throttle body. Remove by pressing on the grey tabs on the PCV line fittings and pulling out.



4. Locate the bolt found above the driver's side strut brace and remove using a 10mm socket.

This concludes removal instructions.

INSTALLATION INSTRUCTIONS

CORSA CATCH CAN SYSTEM



1. Thread in barbed fittings to the catch can ports by hand or by using an 11/16" wrench. **IMPORTANT:** Corsa recommends using thread sealant or PTFE tape on barbed fittings and bottom drain plug to prevent any leaks.



2. Install the catch can bracket and spacer using a 10mm socket and the factory bolt. **NOTE:** The nylon spacer provided by Corsa Performance must be sandwiched between the bracket and the strut brace.



3. Attach the catch can to the bracket using a 2.5mm hex wrench to tighten the 3 screws.

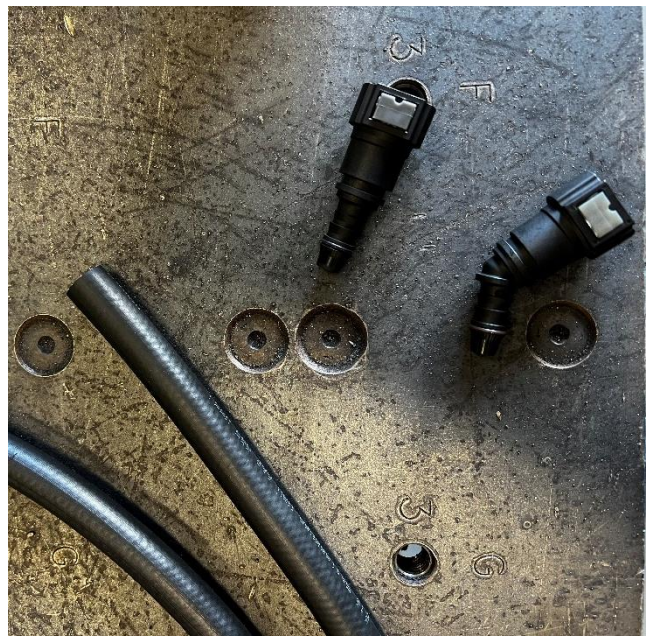

4. Push the quick disconnect fittings over the ends of each hose. The angled fitting attaches the Hose A (shorter hose), and the straight fitting attaches to Hose B (slightly longer hose).

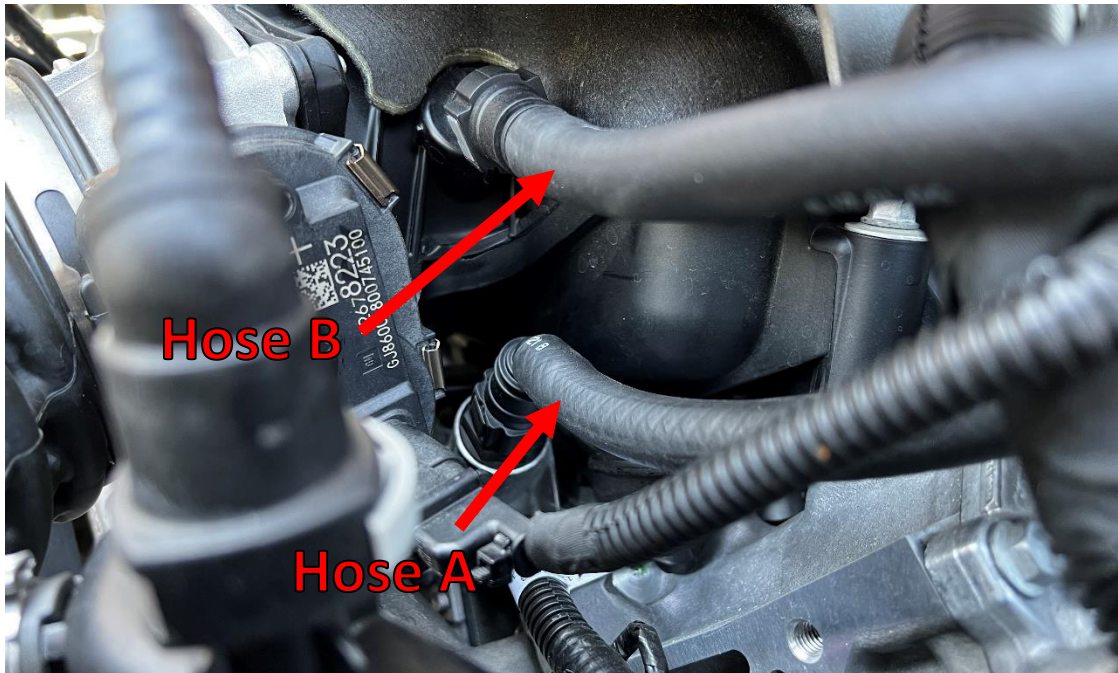

5. Connect the angled fitting and Hose A to lower engine fitting and route the hose back to the side labeled "A" on the catch can. Connect the straight fitting and Hose B to the engine fitting on top and route the hose back to the side labeled "B" on the catch can.



6. Make sure all fittings are secured in place and hose is pushed all the way over the barbed ends of the fittings. Reinstall engine cover and reclip fluid line above the engine cover.

This concludes installation instructions.

*Check that this catch can complies with your Federal, State and Local laws.
We recommend saving your stock PCV line.*

BEFORE ROAD TESTING

- 1.** Start engine, leaving the transmission in park and securing the parking brake.
 - 2.** Make sure to look and listen for any unusual noises or air leaks. Repair problems if needed.
 - 3.** Once completed it will be necessary to check periodically, after a few heat cycles, for realignment and tightening of all connections.
-

EMPTYING CATCH CAN: Twist off the bottom of the catch can and dispose of collected oil. It is recommended to check and empty the catch can with every oil change.